

PAWS 4 STATION IN-LINE 3J MULTI-COLLET FIXTURE

AUTOMATED MULTIPLE-PART WORKHOLDING

Perfect for gripping parts on the outside diameter, the PAWS 3J Multi-Collet fixture allows you to hold multiple-parts on one fixture for gang machining small parts. Ideal for secondary milling operations.

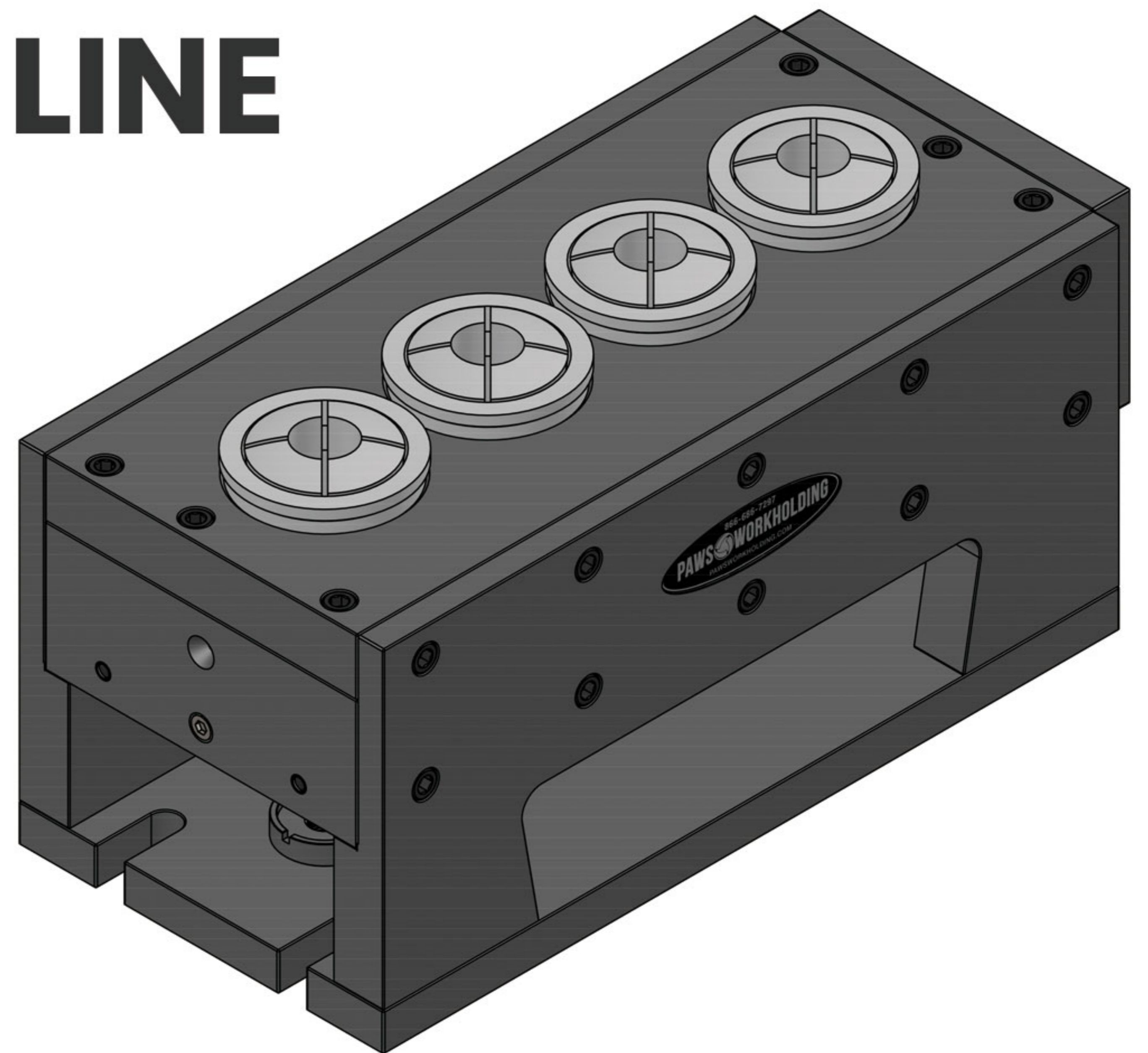

NOTE: HYDRAULIC PUMP AND 3J COLLETS SOLD SEPARATELY.

PART# BMCF-IL04-3J



Uniform Centerline

Fixture has uniform 3.125" centerline with special alignment feature to eliminate radial movement of individual collets.



Push-to-Close Clamping

System uses "Push-to-Close" clamping technology, using a collet sleeve that slides up to close the 5C collet.



Control Z-Height

Easily create threaded part stops to control Z-height dimensions.



Fast Clamping

Hydraulically activated for fast clamping. Run at clamping pressures up to 2,500 lbs.

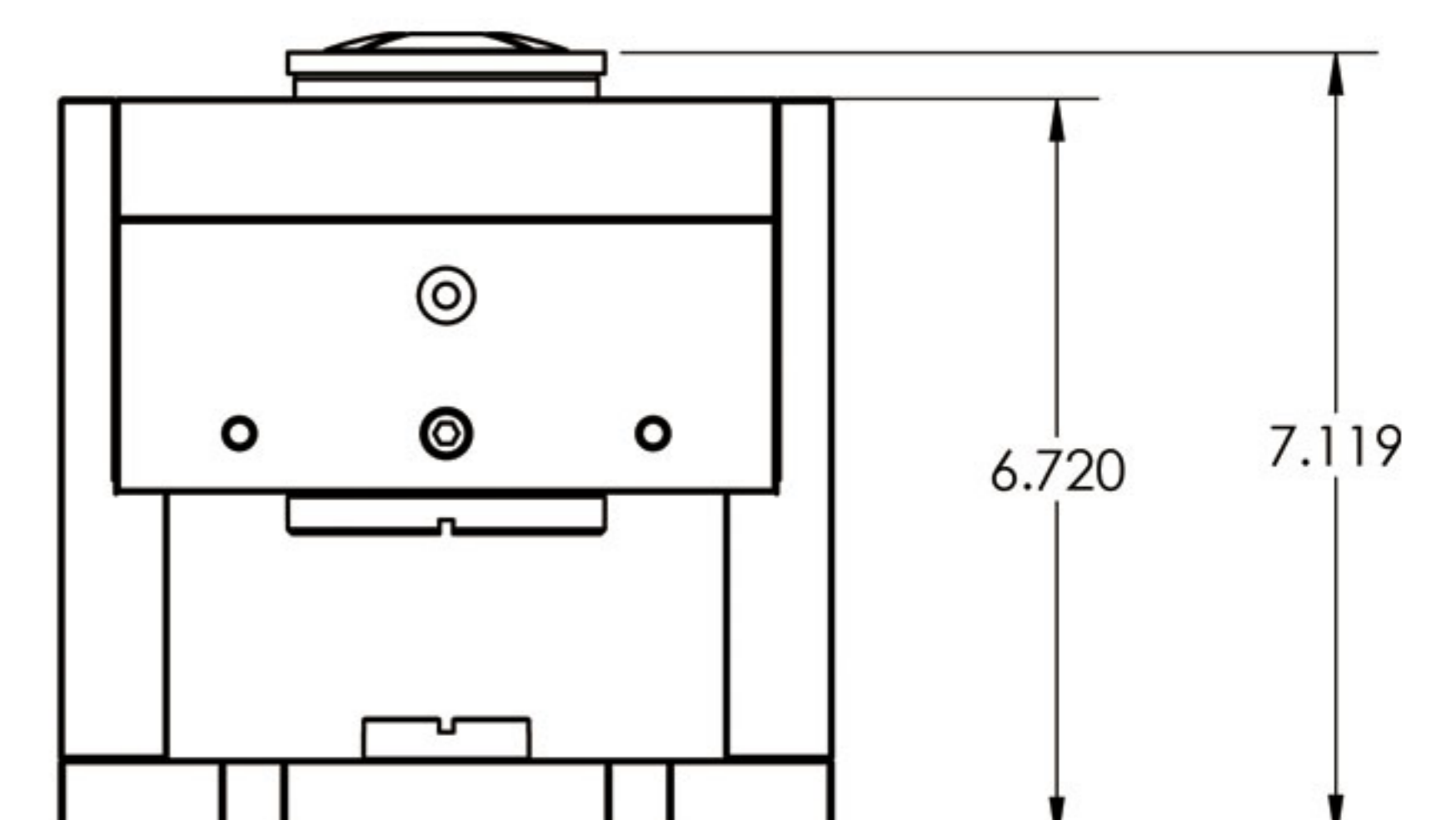
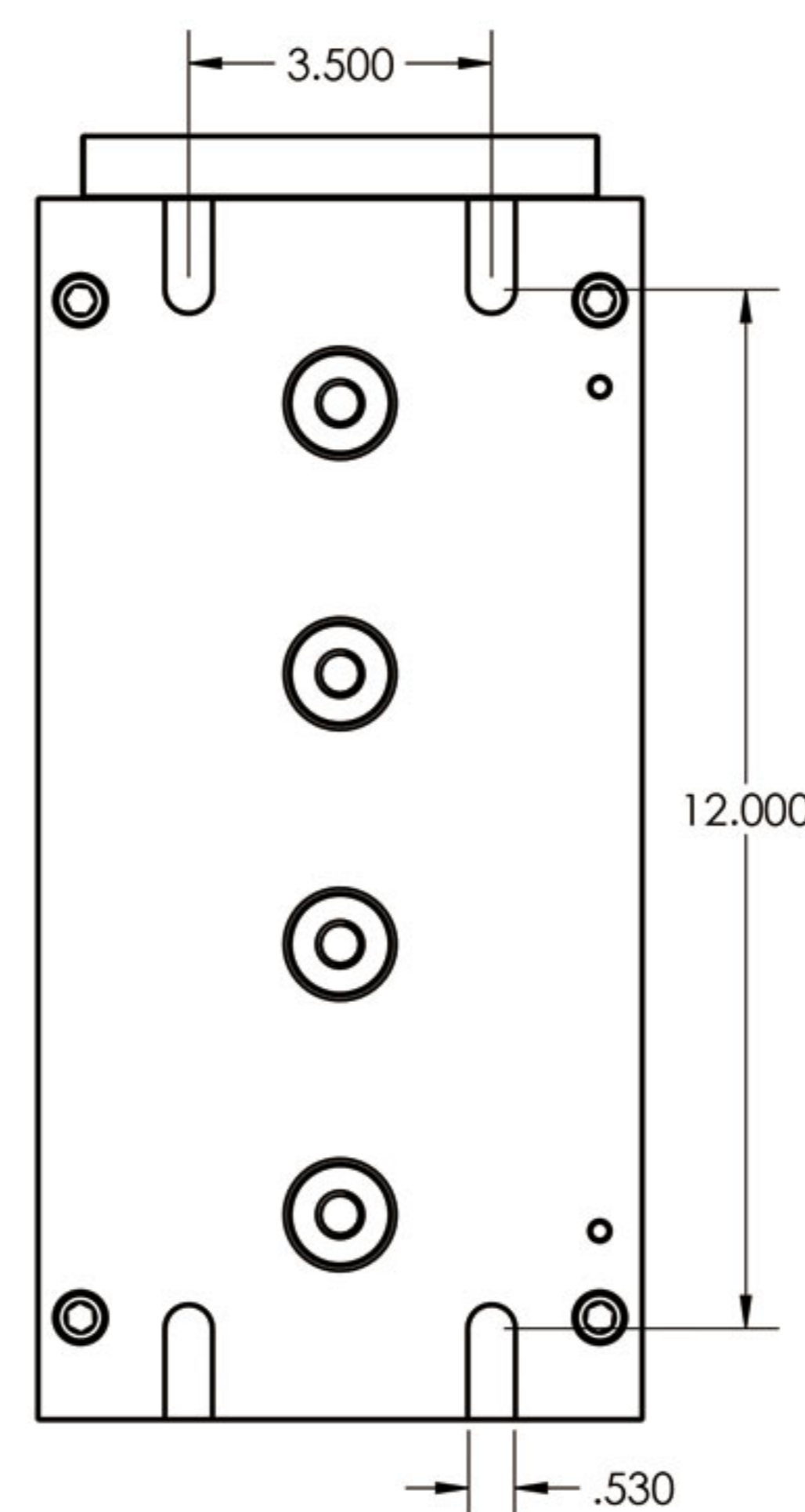
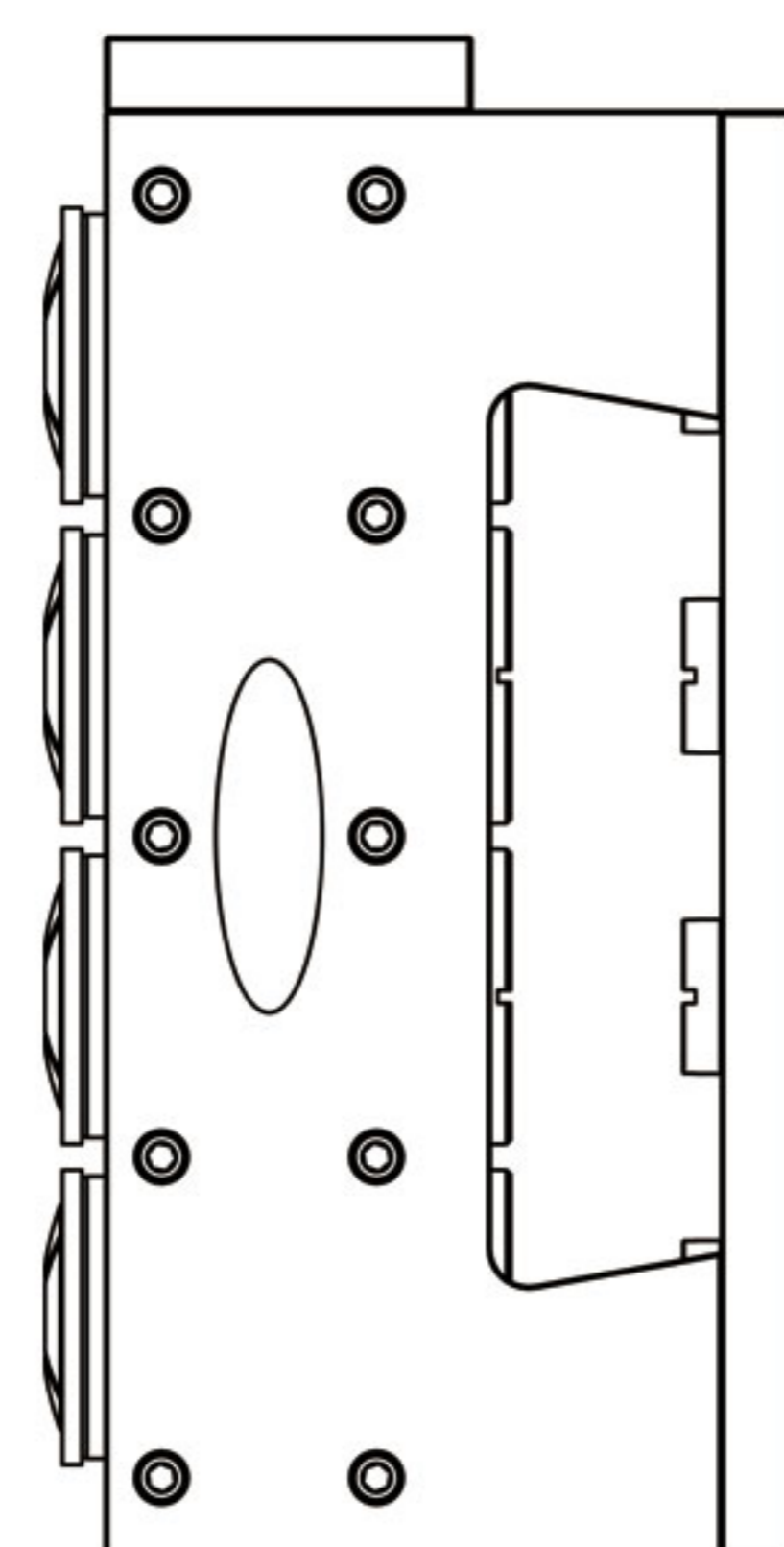
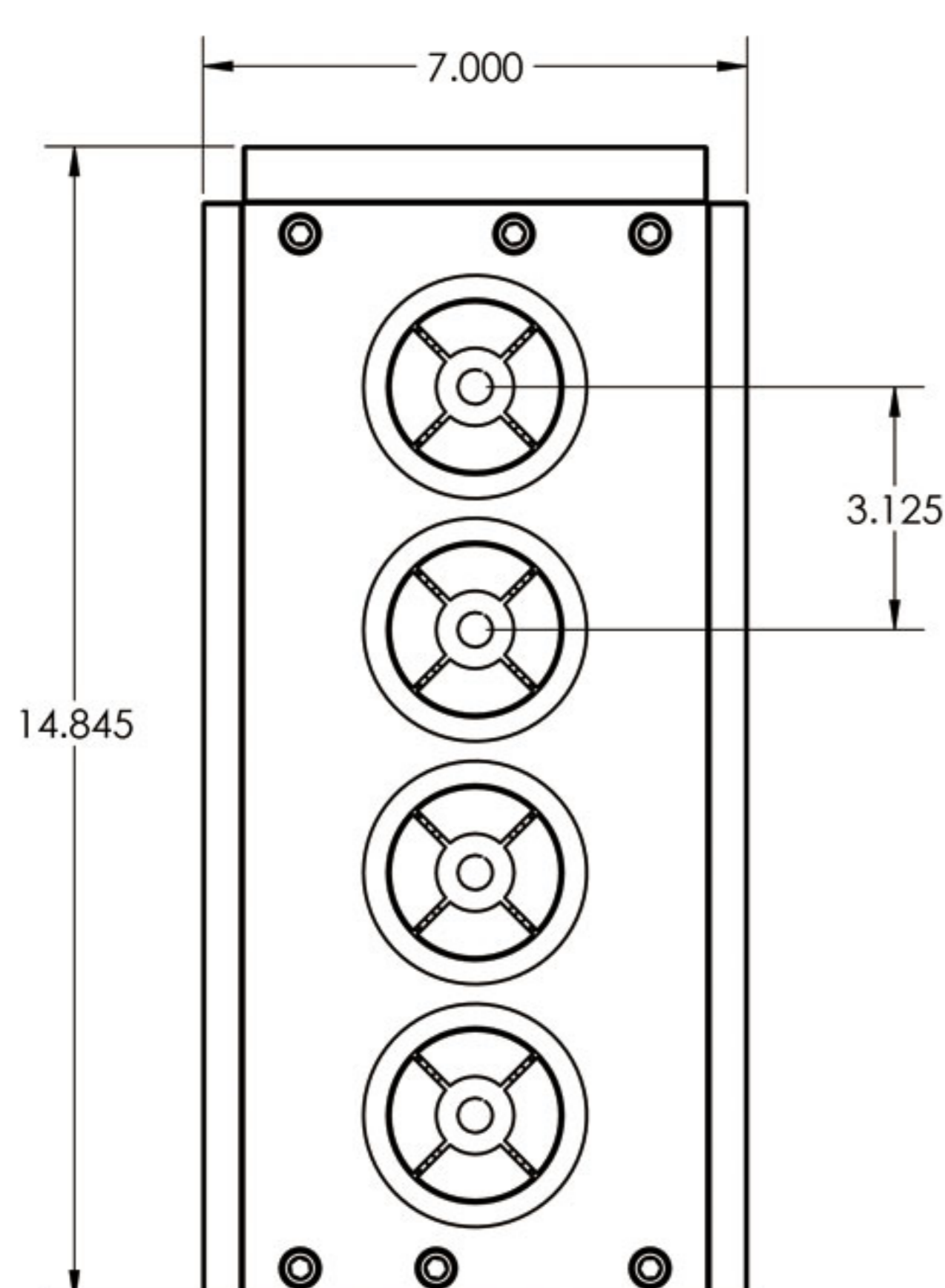

FREE ENGINEERING CONSULTATION!

Call and ask for a Sales Engineer to discuss your application today