

# PAWS 6 STATION IN-LINE 5C MULTI-COLLET FIXTURE

## AUTOMATED MULTIPLE-PART WORKHOLDING

Perfect for gripping parts on the outside diameter, the PAWS 5C Multi-Collet fixture allows you to hold multiple-parts on one fixture for gang machining small parts. Ideal for secondary milling operations.

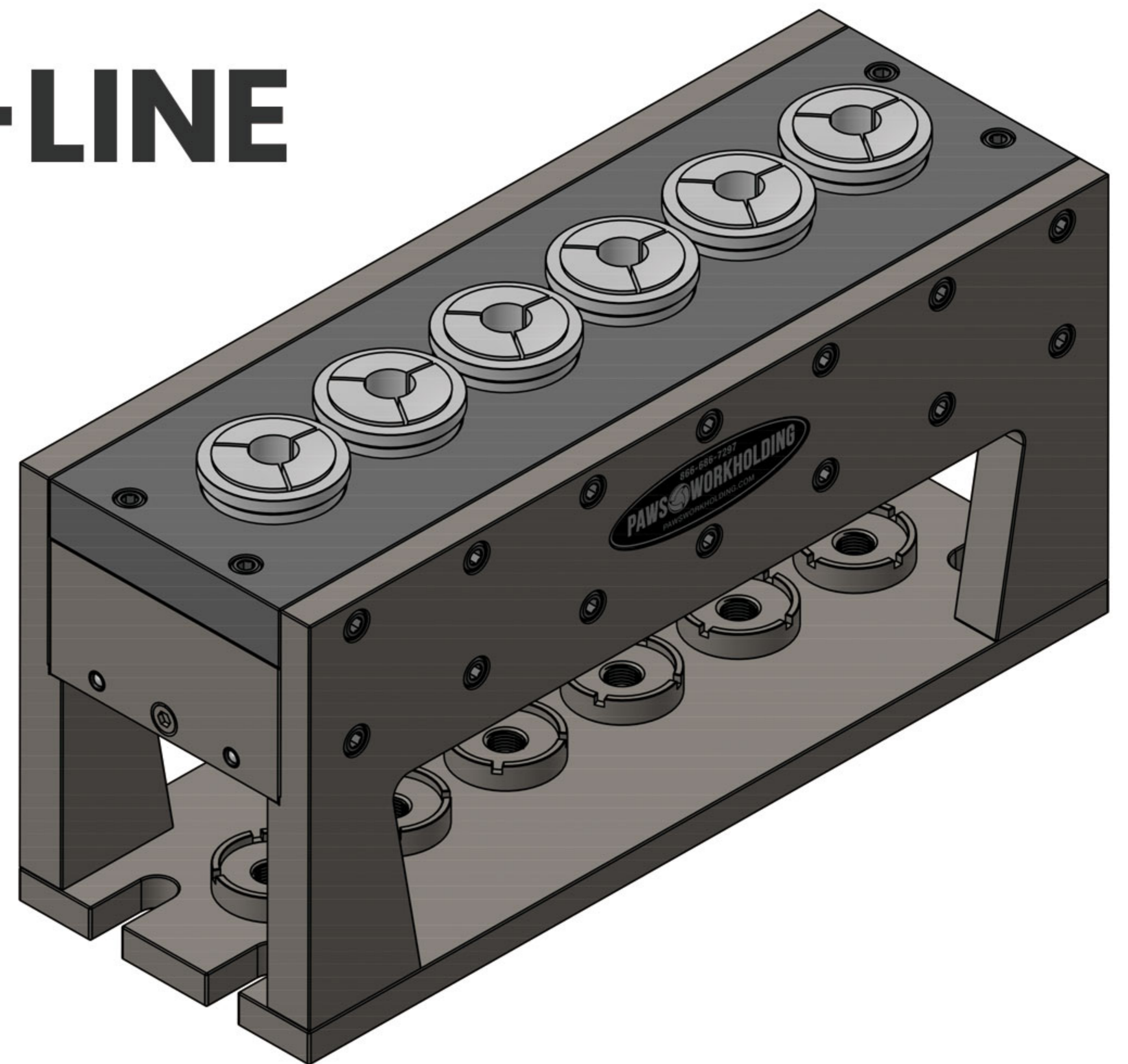

NOTE: HYDRAULIC PUMP AND 5C COLLETS SOLD SEPARATELY.

**PART# BMCF-IL06-5C**



### Uniform Centerline

Fixture has uniform 2.00" centerline with special alignment feature to eliminate radial movement of individual collets.



### Push-to-Close Clamping

System uses "Push-to-Close" clamping technology, using a collet sleeve that slides up to close the 5C collet.



### Control Z-Height

Easily create threaded part stops to control Z-height dimensions.



### Fast Clamping

Hydraulically activated for fast clamping. Run at clamping pressures up to 2,500 lbs.

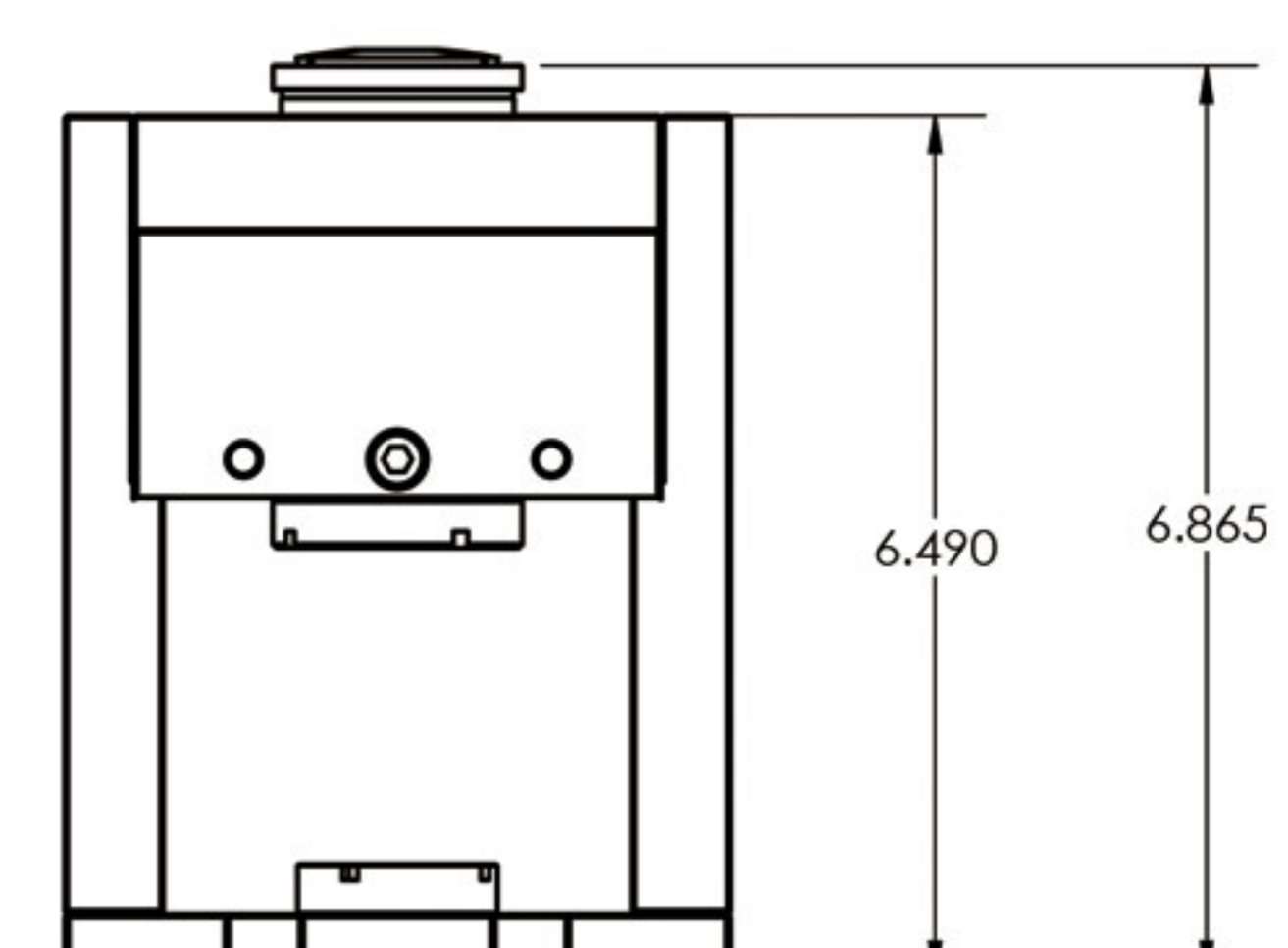
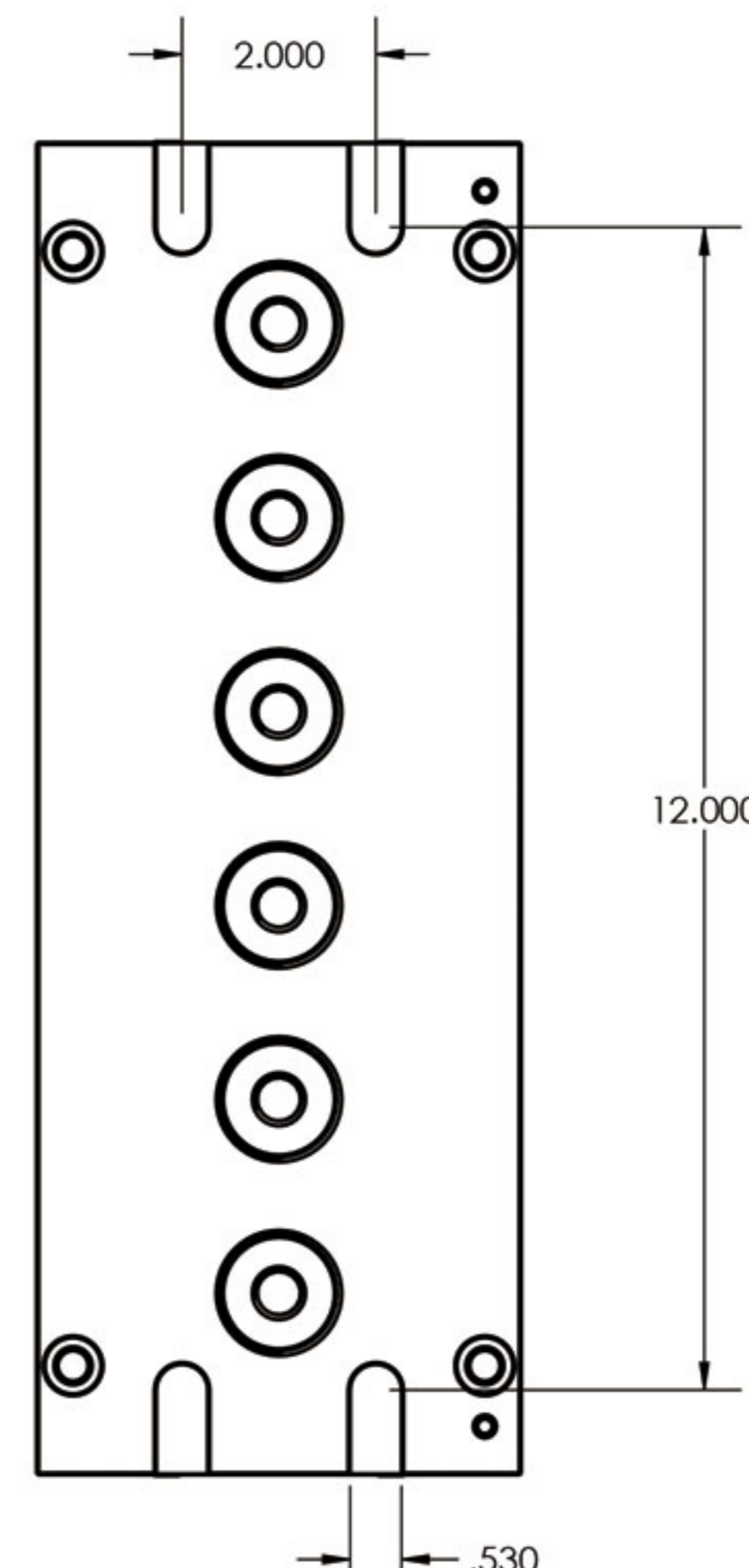
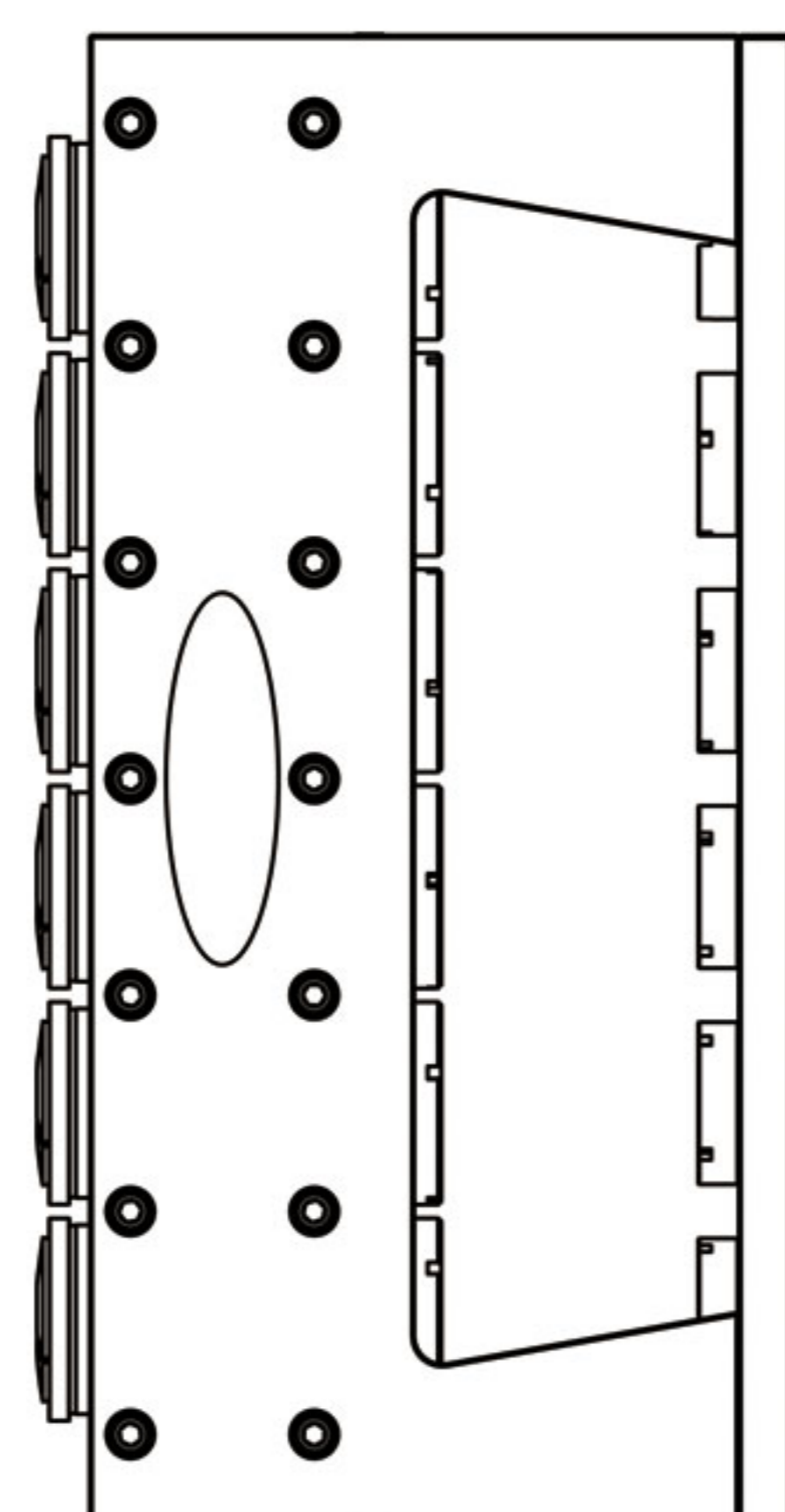
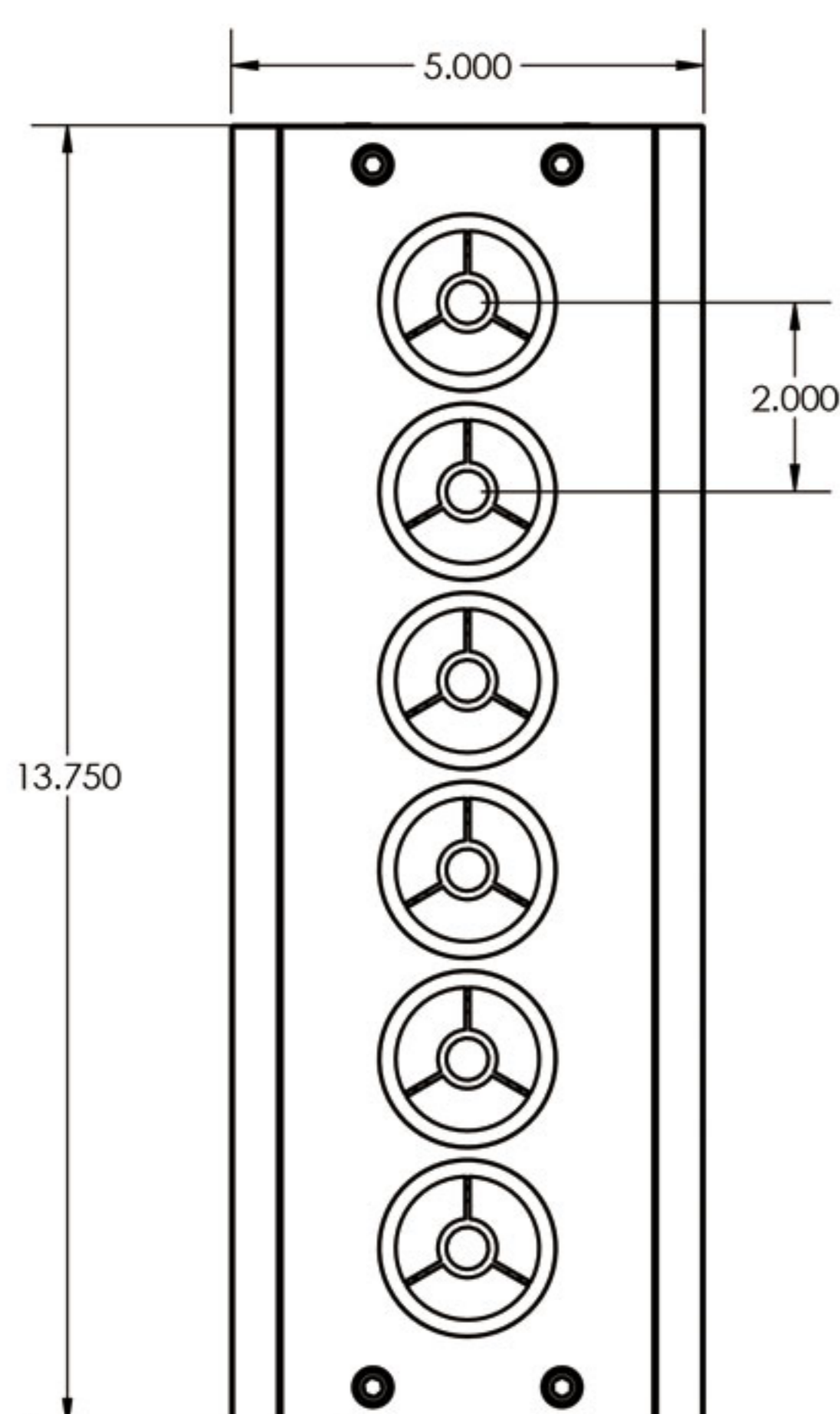

## FREE ENGINEERING CONSULTATION!

Call and ask for a Sales Engineer to discuss your application today